

SURVEY CONTROL DATA

- HORIZONTAL DATUM IS THE OKLAHOMA STATE PLANE COORDINATE SYSTEM, N.A.D. 83(2011) LAMBERT PROJECTION, SOUTH ZONE ADJUSTED TO N.G.S. STATE PLANE COORDINATES, UTILIZING OPUS.
 - ACCURACY - 3RD ORDER OR BETTER
- BEARINGS:

THE BEARINGS SHOWN HEREIN OR HEREON ARE GRID BEARINGS DERIVED FROM THE USC & GS OKLAHOMA PLANE COORDINATE SYSTEM AND ARE NOT ASTRONOMICAL.
- VERTICAL CONTROLS:
 - LEVEL DATUM IS NGS, NAVD 88, TAKEN FROM ADJUSTED PRIMARY CONTROL UTILIZING DIFFERENTIAL LEVELING TECHNIQUES.
 - ACCURACY - 3RD ORDER OR BETTER

LATITUDE 34° 36' 52"
LONGITUDE 98° 35' 52"

DESIGN DATA

ADT 2015 - 192
ADT 2035 - 285
V - 45 M.P.H.
Flex. ESALs - 0.22M

SCALES

PLAN 1:50
PROFILE HOR. 1:50
VER. 1:5
LAYOUT MAP 1" = 5280'

CONVENTIONAL SIGNS

- PROPOSED ROADS
- SECTION LINES
- QUARTER SECTION LINES
- FENCES
- EXISTING GRADE
- EXISTING ROADS
- BASE LINE
- PROPOSED GRADE
- COMMUNICATION LINES (EXISTING)
- POWER LINES (EXISTING)
- GAS LINE (EXISTING)
- SANITARY SEWER LINES (EXISTING)
- WATER LINES (EXISTING)
- COMMUNICATION LINES (PROPOSED)
- POWER LINES (PROPOSED)
- GAS LINE (PROPOSED)
- SANITARY SEWER LINES (PROPOSED)
- WATER LINES (PROPOSED)
- BUILDINGS
- DRAINAGE STRUCTURES (EXISTING)
- DRAINAGE STRUCTURES (PROPOSED)
- RIGHT-OF-WAY LINES (EXISTING)
- RIGHT-OF-WAY LINES (PROPOSED)
- RIGHT-OF-WAY FENCE
- FLOWLINE (EXISTING)
- FLOWLINE (PROPOSED)
- TOE OF SLOPE (EXISTING)
- TOE OF SLOPE (PROPOSED)
- CITY LIMITS
- LANDSCAPE

STATE OF OKLAHOMA
DEPARTMENT OF TRANSPORTATION

PLAN OF PROPOSED
COUNTY BRIDGE

BRIDGE AND APPROACH PLANS
**TRIBUTARY TO BLUE BEAVER CREEK
COMANCHE COUNTY**

PROJECT NO. CIRB-216C(074)RB

STATE JOB NO. 30440(04)

LOCATION: 16N2460E1650007

REMOVE NBI NO. 14582 CONSTRUCT NBI NO. 31581

INDEX OF SHEETS

SHEET NO.	DESCRIPTION
0001.	TITLE SHEET
0002.	TYPICAL SECTION AND MISCELLANEOUS DETAILS
AR01.	SUMMARY OF PAY QUANTITIES AND GENERAL NOTES
AR02.	SUMMARY TABLES AND GUARDRAIL BENDING DETAIL
B001.	BRIDGE "A" GENERAL PLAN & ELEVATION
B002.	GEOTECHNICAL INFORMATION
R001.	STORM WATER MANAGEMENT PLAN
R002.	EROSION CONTROL PLAN
R003-R004.	PLAN AND PROFILE
X001. - X010.	X - SECTIONS

THE FOLLOWING STANDARDS WILL BE REQUIRED FOR THIS PROJECT.

2009 COUNTY BRIDGE	ROADWAY 2009	TRAFFIC 2009
CB26-C-SK30-ABUT-PC4-1-01E	SSS-1-1	GRAU1-1-00
CB26-C-SK30-ABUT-PC4-2-02E	TSC2-3-2	GRH1-1-00
CB26-C-SK30-XSECT-PC234-01E	TSO-2-0	GRH2-1-00
CB26-C-SK30-LSECT-PCB-01E	PSE-1-0	TCS1-1-01
CB26-C-SK30-DKSLB-1-01E	PCES-4-1	TCS2-1-00
CB26-C-SK30-DKSLB-2-01E	SPI-4-1	TCS4-1-01
CB26-C-SK30-DKSLB-BLIST-01E	SPB-1-4	TCS5-1-00
CB26-C-SK30-DIA-END-PC234-01E	FHTMPP-1-0	TCS7-1-02
CB26-C-SK30-SPR-QUAN-PCB-1-01E	MI-3-0	TCS9-1-01
CB26-C-SK0.30-PCB-IV-105-01E	RDI-3-1	DU2-1-00
CB26-C-SK0.30-DIA-INT-PCB-01E	DC-3-2	
CB26-C-SK0.30-BRG-PC4-01E		
CB26..32-C-SK30-WING-PC4-01E		
CB26..32-C-SK30-ABUT-MISC-01E		
CB26..32..C.I..SKO.30-GRAU-BC-00E		

2009 STATE BRIDGE
HP1-2-01E
TR3-2-01E

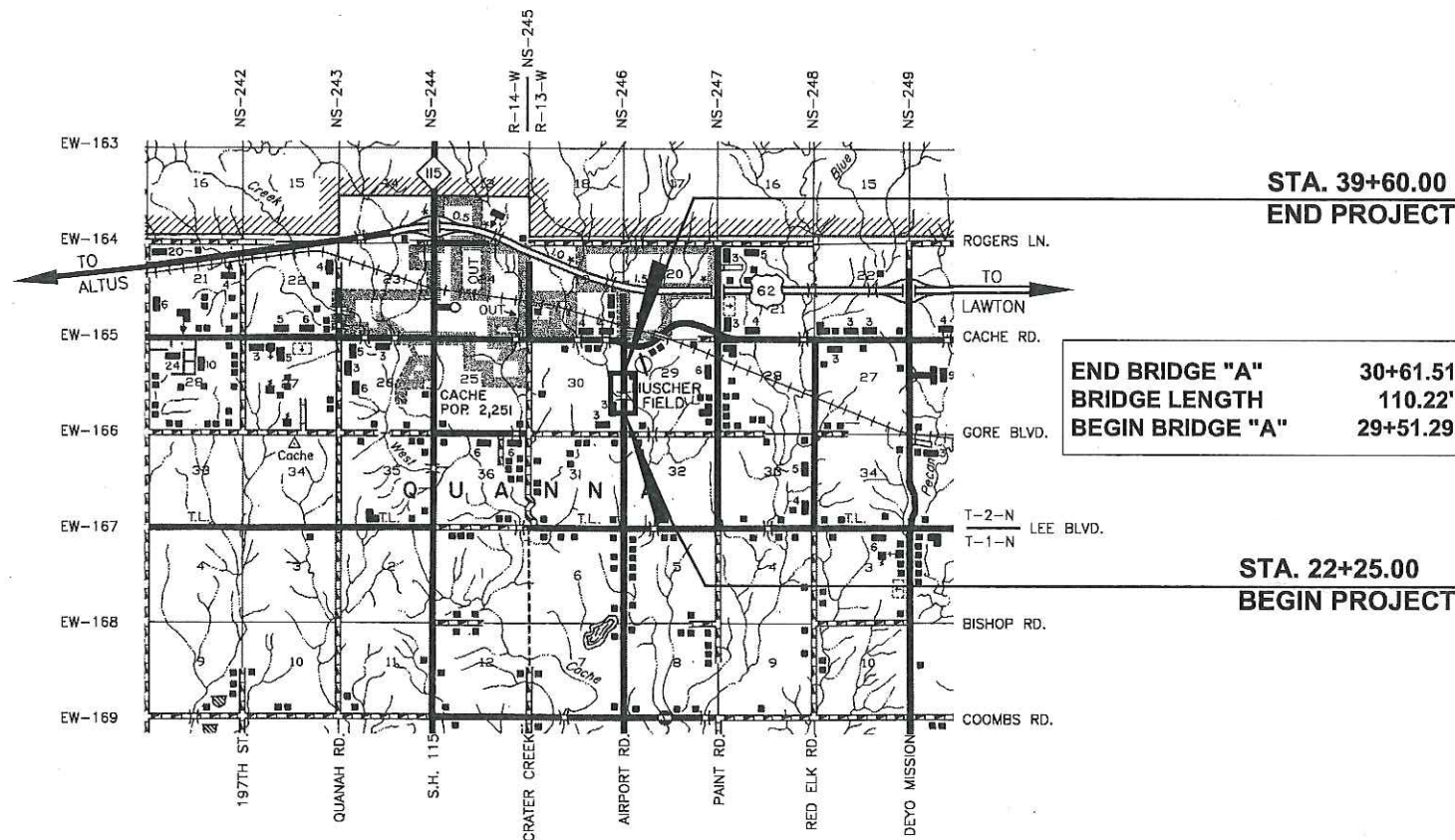

APPROVED
COMANCHE COUNTY BOARD OF COMMISSIONERS

DISTRICT NO. 1 DATE: October 16 2016
 DISTRICT NO. 2 DATE: October 16 2016
 DISTRICT NO. 3 DATE: October 16 2016

ATTEST
 COUNTY CLERK DATE: October 16 2016

PREPARED BY:
CEC CORPORATION
CA32 PE/LS 6/30/2018
OKLAHOMA CITY, OKLAHOMA

CEC

AMANDA FAY BAKER
26474
OKLA. REG. NO. 26474

AMANDA FAY BAKER
OKLA. REG. NO. 26474

DATE: 8-8-17

OKLAHOMA DEPARTMENT OF TRANSPORTATION	DEPARTMENT OF TRANSPORTATION FEDERAL HIGHWAY ADMINISTRATION
DATE APPROVED	DATE APPROVED
BY	BY
CHIEF ENGINEER	DIVISION ADMINISTRATOR
PROJECT NO. CIRB-216C(074)RB	SHEET NO. 0001

PROJECT LENGTH BASED ON C.R.L.

ROADWAY LENGTH: 1,627.78 FT. 0.307 MILES
 BRIDGE "A" LENGTH: 110.22 FT. 0.020 MILES
 PROJECT LENGTH: 0.328 MILES

EQUATIONS: NONE
 EXCEPTIONS: NONE

2009 OKLAHOMA STANDARD SPECIFICATIONS FOR HIGHWAY CONSTRUCTION GOVERN, APPROVED BY THE U.S. DEPARTMENT OF TRANSPORTATION, FEDERAL HIGHWAY ADMINISTRATION, JANUARY 4, 2010.

DON HAWTHORNE
COMMISSIONER, DISTRICT NO. 3
COMANCHE COUNTY

SHELLY MOODY
LOCAL GOVERNMENT DIVISION
OKLAHOMA DEPARTMENT OF TRANSPORTATION

P.E. NO. 30440(01)